

KUGELKUPPLUNGSSYSTEM - BALL COUPLING SYSTEM

Typ/Type 5085 T

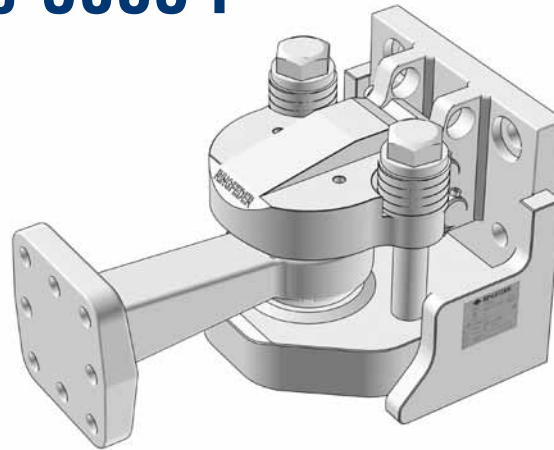



Montage



Bedienung



Wartung



Reparatur

Diese Einbau- und Betriebsanleitung gilt für die Spezial-Kugelkupplung **RINGFEDER Type 5085 T**.

Die Anwendung der Spezial-Kugelkupplung Typ 5085 T ist auf Zentralachsanhänger bei Auto-transportern beschränkt. Diese Fahrzeuge haben eine spezielle Konstruktion, die eine besondere und unübliche Anordnung der Kupplung erforderlich machen kann.

Der Gebrauch der Spezial-Kugelkupplung Typ 5085 T ist begrenzt auf Zentralachsanhänger der Klasse „**0**“ mit **Zugöse der Klasse D50** gemäß Anhang 5, Absatz 4 der Richtlinie R55-01 oder ISO-Norm 1102. Andere Ausführungen von Zugösen dürfen nicht mit der Kugelkupplung Typ 5085 T verbunden werden. Die Mindestdicke der Zugöse, die mit der Spezial-Kugelkupplung Typ 5085T gekuppelt wird, muss im Augenbereich 44,5 mm betragen.

Reparaturen sollten nur durch Fachwerkstätten ausgeführt werden.

Beim Austausch von Ersatzteilen der Kupplung dürfen nur Original **RINGFEDER** Ersatzteile verwendet werden; andernfalls erlischt jegliche Garantie.

Symbole



Schraube



Scheibe Mutter



Schlüsselweite



Anzugsmoment



Kupplung offen



Kupplung geschlossen und gesichert



Visuelle Kontrolle



Verschleißteile ersetzen



Montage



Demontage



Größe



Anziehdrehmoment



Abkuppelvorgang

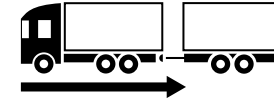

Ankuppelvorgang

Typ	Klasse	ECE Typgenehmigung	Dc-Wert kN	V-Wert kN	S-Wert kg	Bestellnummer
5085 T	T	E11 55R-018212	140	75/55	1000/2000	14 996 839



Installation



Operation



Maintenance



Repair

These installation and operation instructions apply to Dedicated Ball Coupling **RINGFEDER Type 5085 T**.

The use of type 5085 T Dedicated Ball coupling is restricted to Centre Axle Trailer on Car Transporter Vehicles. These Vehicles have special structures and may need a particular and unusual location of the coupling.

The use of type 5085 T Dedicated Ball coupling is restricted to class "O" centre axle trailer using class **D50 Drawbar eye** according to Annex 5, para. 4 of the regulation R55-01 or ISO 1102. No other types of drawbar eye can be matched with Type 5085 T Ball type coupling.

The minimum thickness of the drawbar eye to be coupled to type 5085T dedicated ball coupling must be 44,5mm in the area of the eye.

Repairs should only be carried out by a professional workshop.

When replacing component parts of the coupling only original **RINGFEDER** spare parts are to be used otherwise every guarantee ceases.

Symbols



Screw



Washer Nut



Wrench size



Tightening torque



Coupling open



Coupling closed and secured



Sight check



Replace used wear parts



Assembly



Disassembly



Size



Tightening torque



Uncoupling procedure

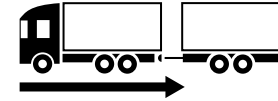

Coupling procedure

Type	Class	ECE type approval	Dc-Value kN	V-Value kN	S-Value kg	Order number
5085T	T	E11 55R-018212	140	75/55	1000/2000	14 996 839





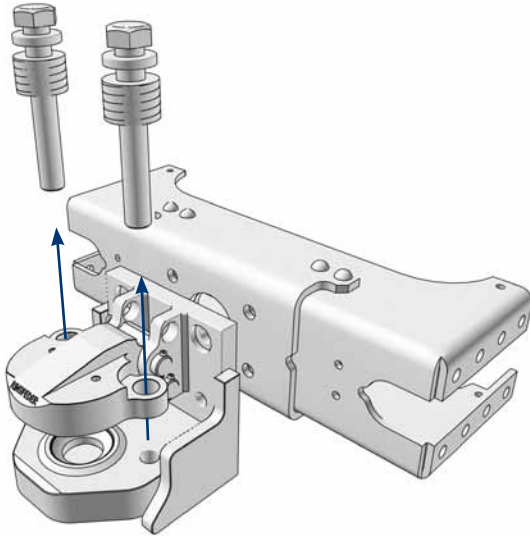

A1

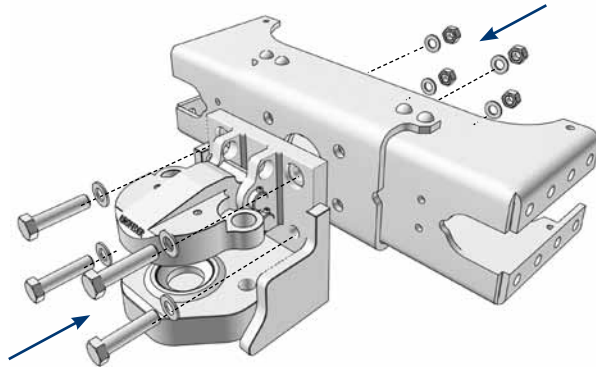

A2





				
M20 x 100 DIN 933 (≥ 8.8)	≥ 200 HV	≥ 8	Nm 380-420	mm 30



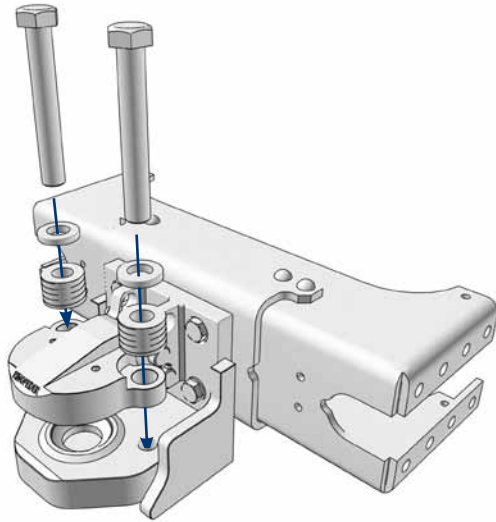

A3

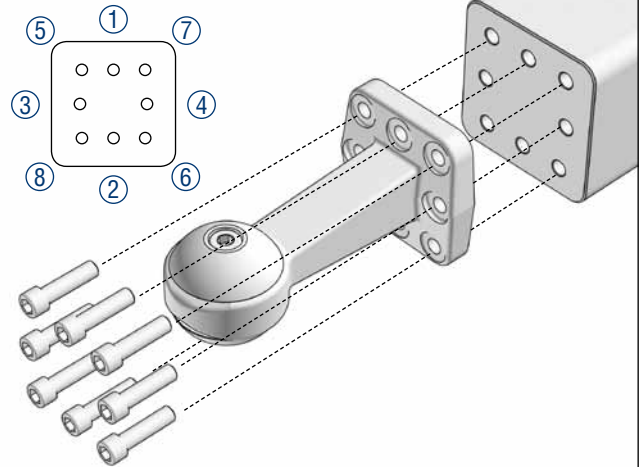

 Nm	 mm
625-650	46

A4



 Nm	 mm
250-280	14



B1

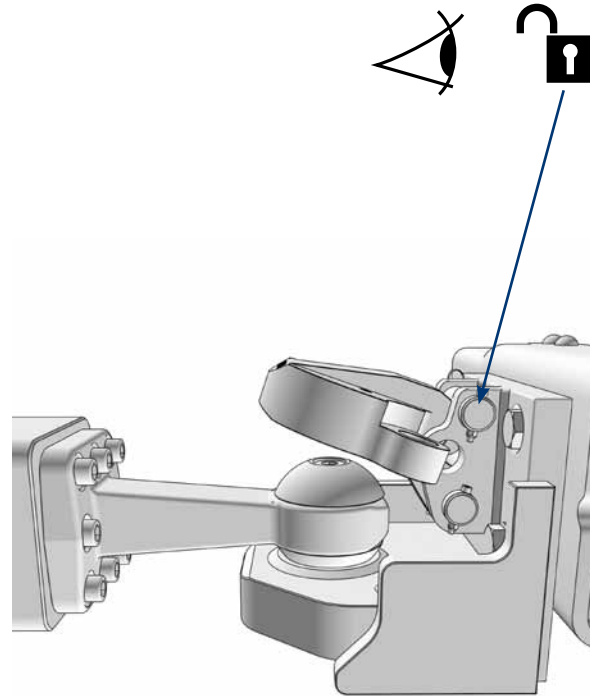
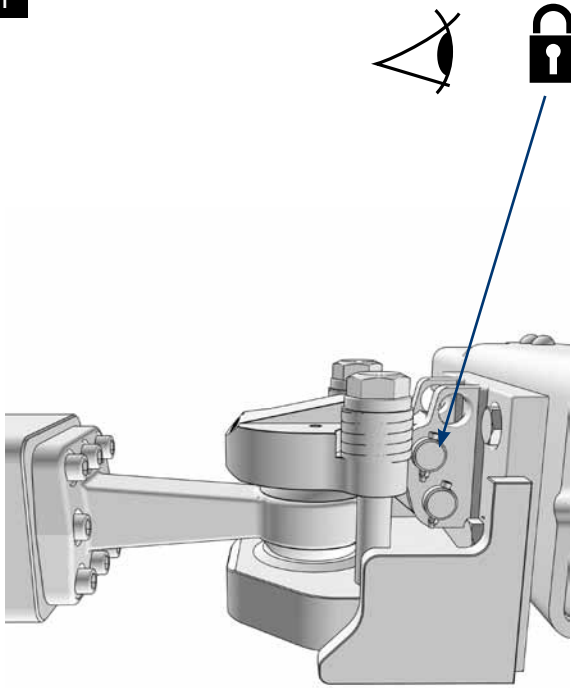

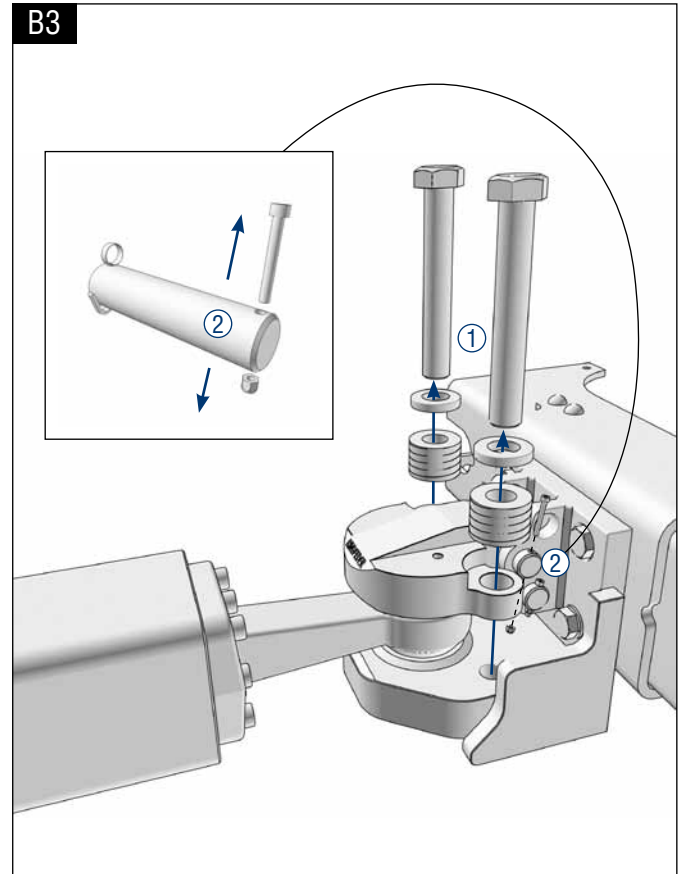
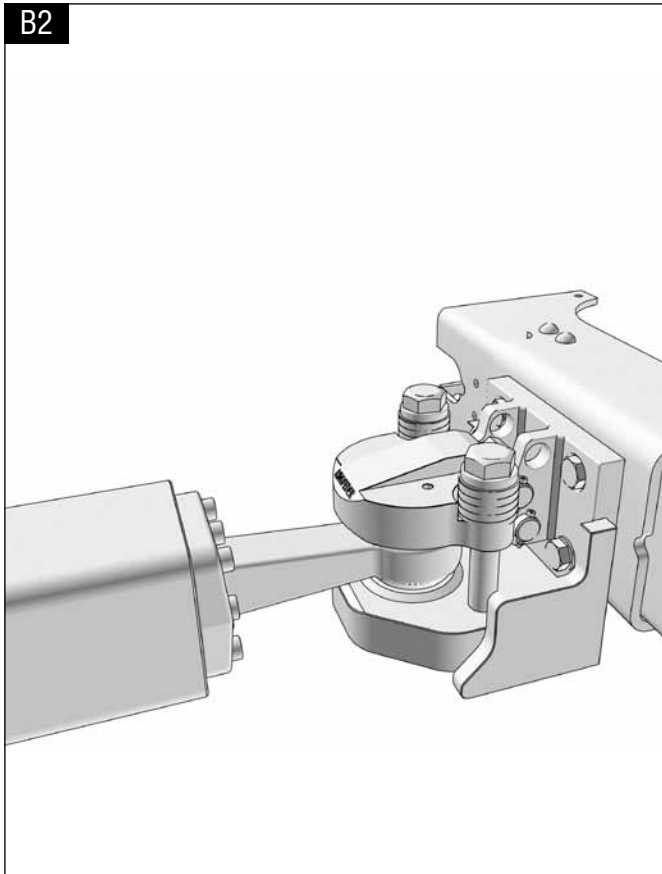



B4

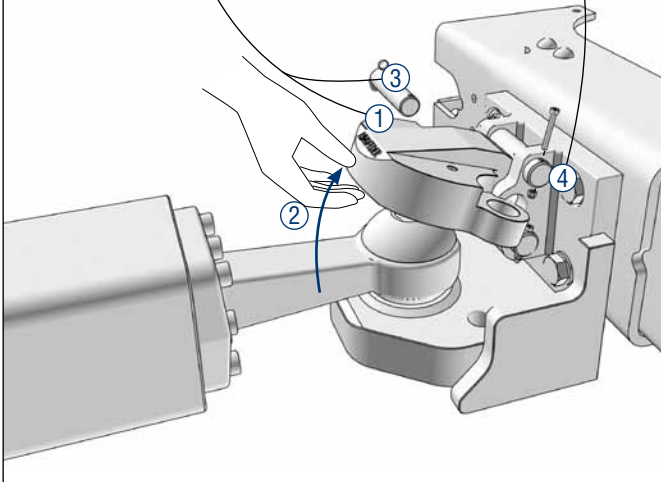
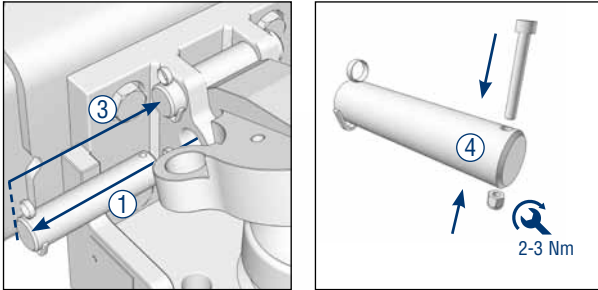

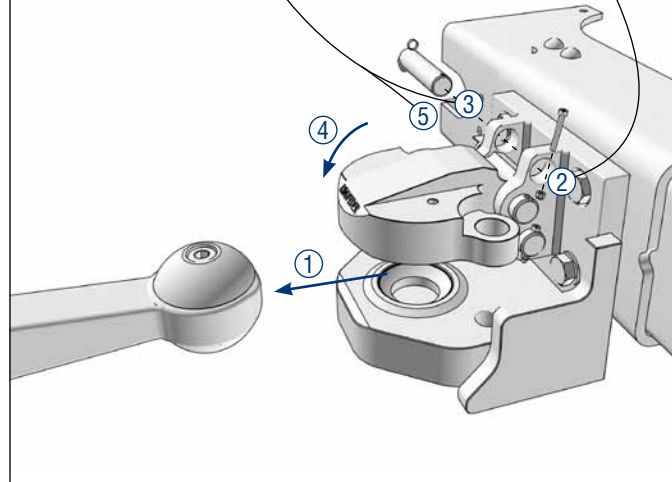
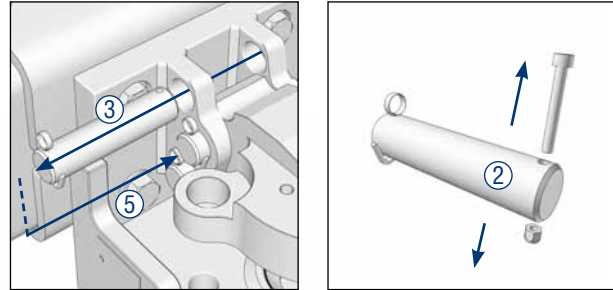

B5



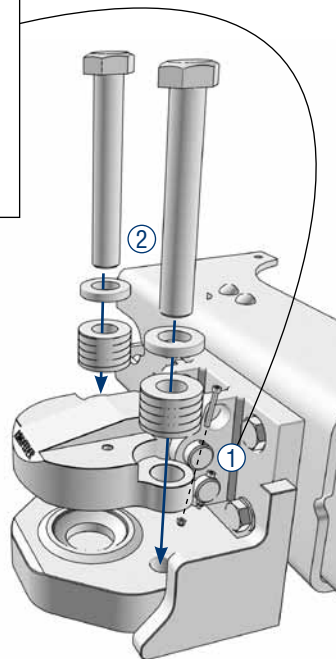
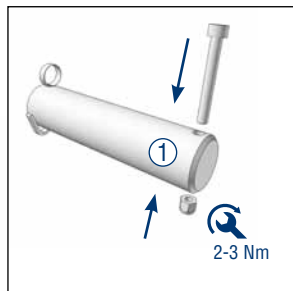

B6



 Nm	 mm
625-650	46

B7

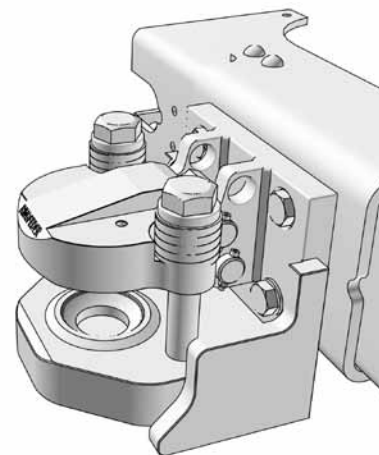

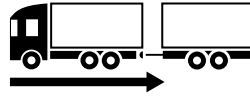

B8

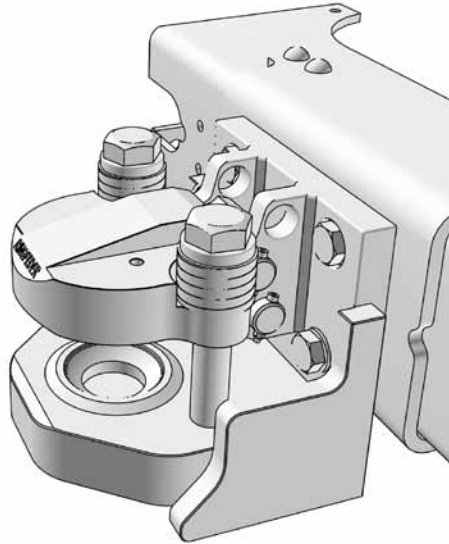

B9

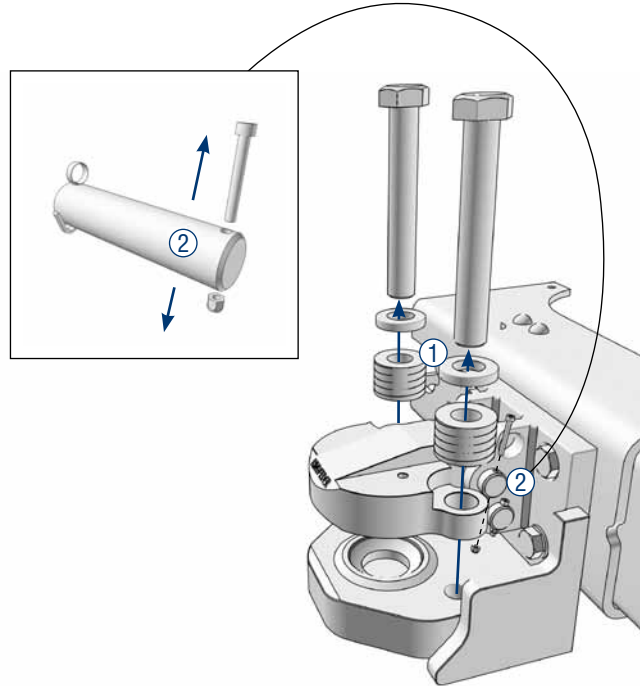

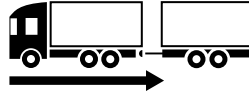

B10

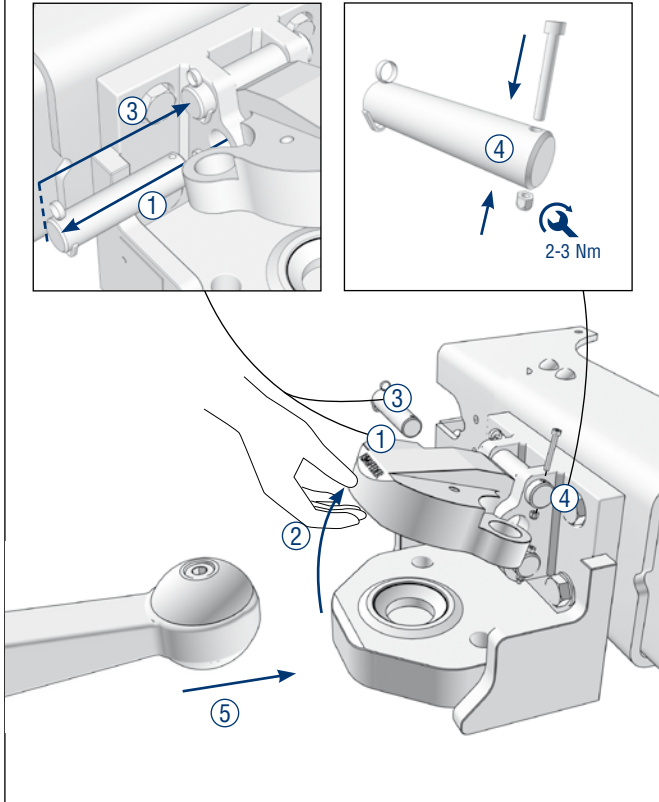

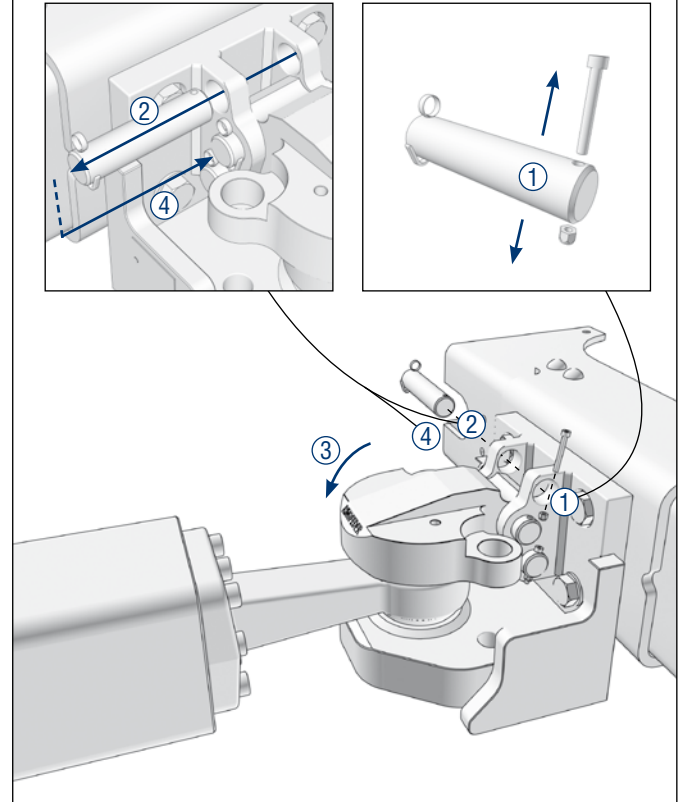

B11

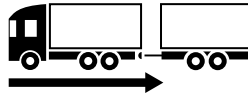

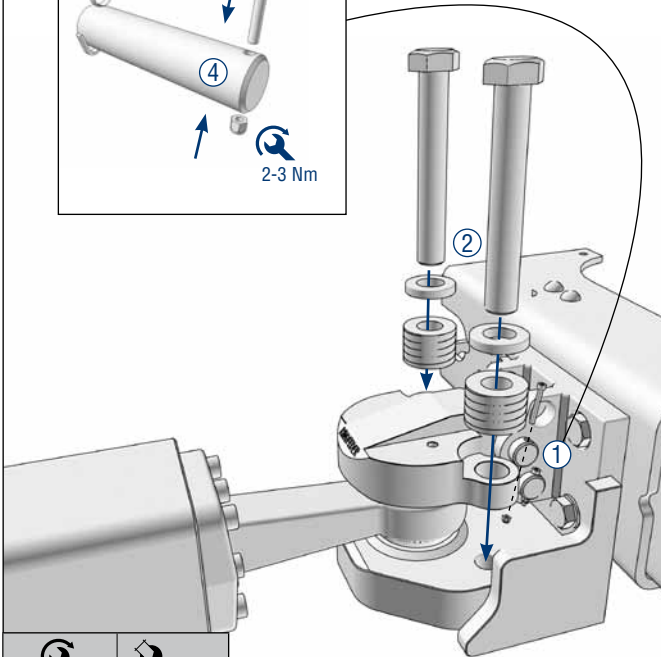
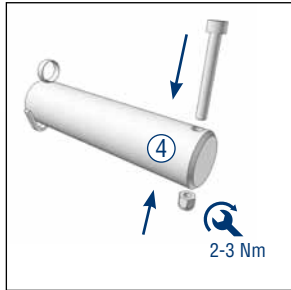

B12



 Nm	 mm
625-650	46

B13

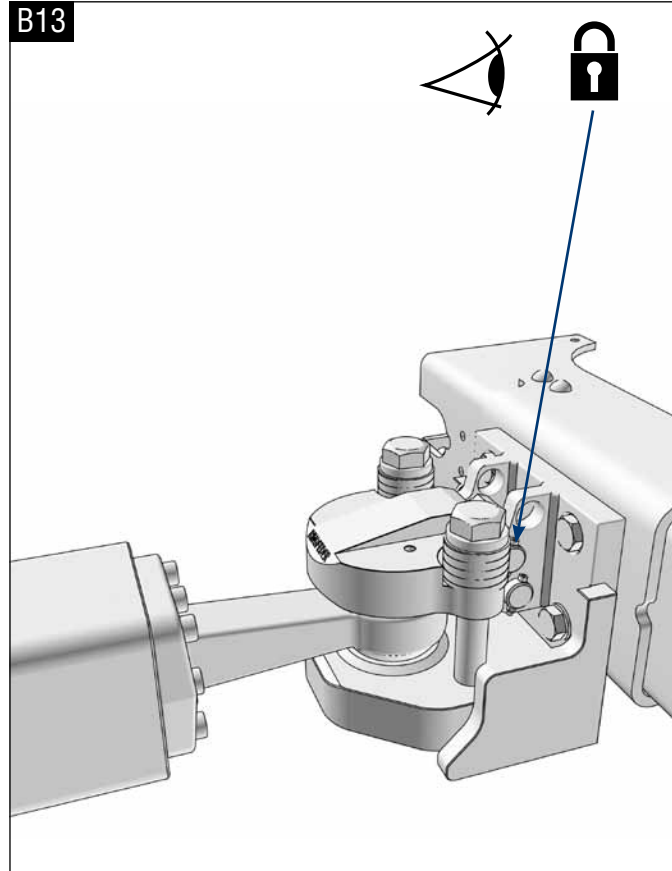



C1

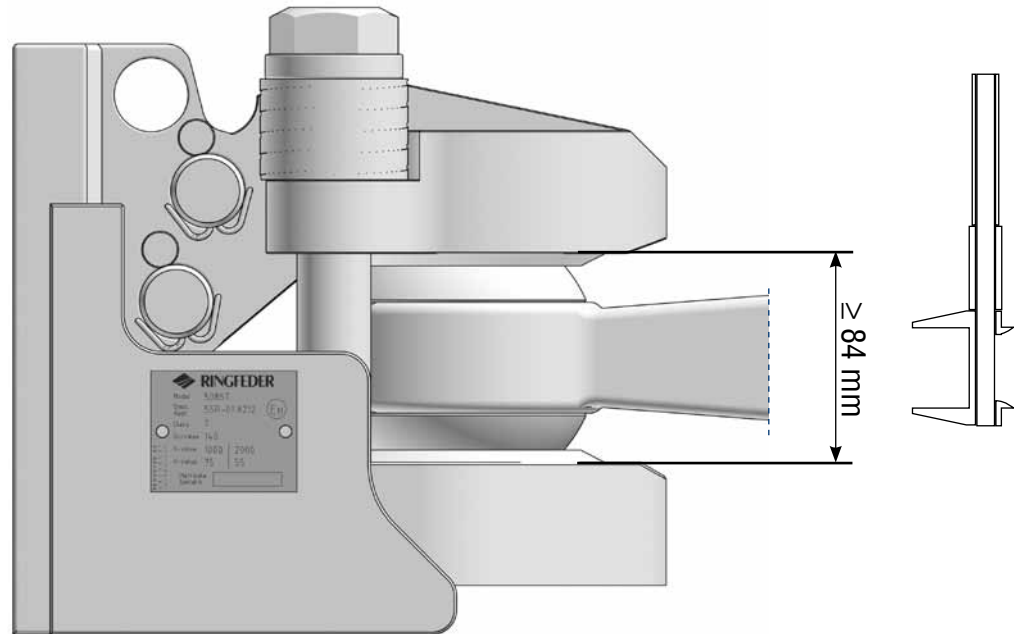



Produced in a certified company DIN EN ISO 9001:2008

VBG GROUP TRUCK EQUIPMENT GMBH · Oberschlesienstr. 15 · D-47807 Krefeld · P.O. Box 130655 · D-47758 Krefeld
Phone +49 (0) 2151 835-0 · Fax +49 (0) 2151 835-200 · www.ringfeder.de · e-mail: info@ringfeder.de