

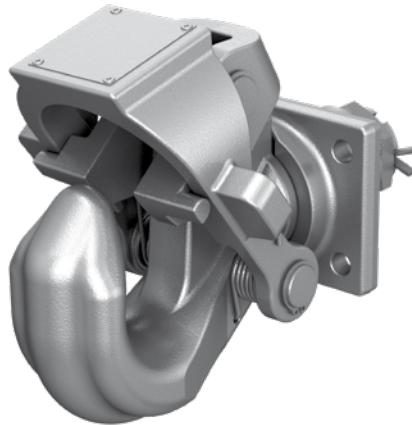

RINGFEDER® Typ / Type RUwg K0 D





Montage



Bedienung



Wartung

Diese Montage- und Betriebsanleitung gilt für die nicht automatische Hakenkupplungen RINGFEDER der Baureihen RUwg K0 D.

Beim Anbau (bzw. Austausch) der Hakenkupplung sind die einschlägigen gesetzlichen Bestimmungen und die Angaben der Fahrzeughersteller zwingend zu beachten! Beim Austausch der Hakenkupplung sind alle im Lieferumfang enthaltenen Teile der Hakenkupplung zu wechseln. Der Anbau der Hakenkupplung ist sinngemäß entsprechend den Forderungen des Anhangs VII der Richtlinie ECE 55-01 vorzunehmen. Montage und Wartung müssen sorgfältig und fachmännisch durchgeführt werden.

Von den nachfolgenden Angaben sind eventuell abweichende Schrauben- und Mutternormen der Befestigungsschrauben und selbstsichernden Ganzmetallmutter der Fahrzeughersteller zu beachten! Alternativ zu der Verschraubung mit Scheiben können auch entsprechende Flanschkopfschrauben und Flanschmutter verwendet werden, wobei dann die Scheiben entfallen.

Seite 4

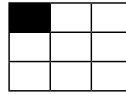

Tabellen

Nicht automatische
Hakenkupplung

Lochbild (e1 x e2)



Schraube



Scheibe



Mutter



Typgenehmigung, ABG



Schlüsselweite



Anzugsmoment

Zulässige Anhängelast des
Starrdeichselanhängers

Seite 5-14

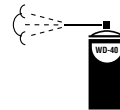
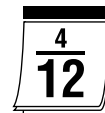

Kupplung offen

Kupplung
geschlossen
und gesichertVisuelle
KontrolleAchtung! Verletzungs-
gefahr – Hand wird
gequetschtSchmiermittel
WD-40Intervall
1 x pro Quartal



Installation



Operation



Maintenance

These installation and operating instructions apply to non-automatic RINGFEDER hook type couplings of the series RUwg KO D.

When fitting (or replacing) the trailer coupling, always attend to the relevant statutory regulations and the particular information from the vehicle manufacturers. When replacing the trailer coupling all component parts of the trailer coupling comprised in the delivery have to be exchanged. Fitting of the trailer coupling on the vehicle has to be made in compliance with the requirements laid down in appendix VII of the ECE 55-01 regulation. Installation and maintenance works have to be carried out carefully and professionally.

When it comes to the fastening screws and all-metal self-locking nuts, always attend to the qualities given by the vehicle manufacturers that may possibly deviate from the present specifications. Alternatively to a screwed connection using washers, also corresponding flange head screws and flange nuts can be used, in which case the washers can be dropped.

Page 4

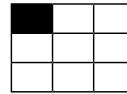

Tables



Non -automatic Hook Coupling



Flange design (e1 x e2)



Screw



Washer



Nut



Type Approval, ABG



Wrench size



Tightening torque



Admissible trailer load for rigid drawbar trailers

Page 5-14



Coupling open



Coupling closed and secured



Sight check



Attention: Risk of injury – jammed fingers.

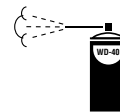







Lubricant WD-40

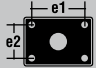



Interval: Once per quarter

1		

						
e1 x e2 (mm)	Ø d2 (mm)		ISO 7089	ISO 7042	Nm (± 5%)	mm
83 x 56	10,5	M10	≥ 200HV	≥ 8	49	17/16

2		

Typ / Type	ABG	ECE 55-01	D - Wert D - Value D (kN)	S - Wert S - Value S (kg)	Zul. Anhängelast des Starrdeichselanhängers Admissible trailer load for rigid drawbar trailers	Dc - Wert Dc - Value Dc (kN)	V - Wert V - Value V (kN)
							
RUwg K0 D S	F 3226	-	21	250	3500	-	-
RUwg K0 D	F 3226	-	12,5	100	2500	-	-
RUwg K0	-	-	12,5	200	2000	-	-
RUwg K0 E	-	2475	25	250	-	20	10



A1

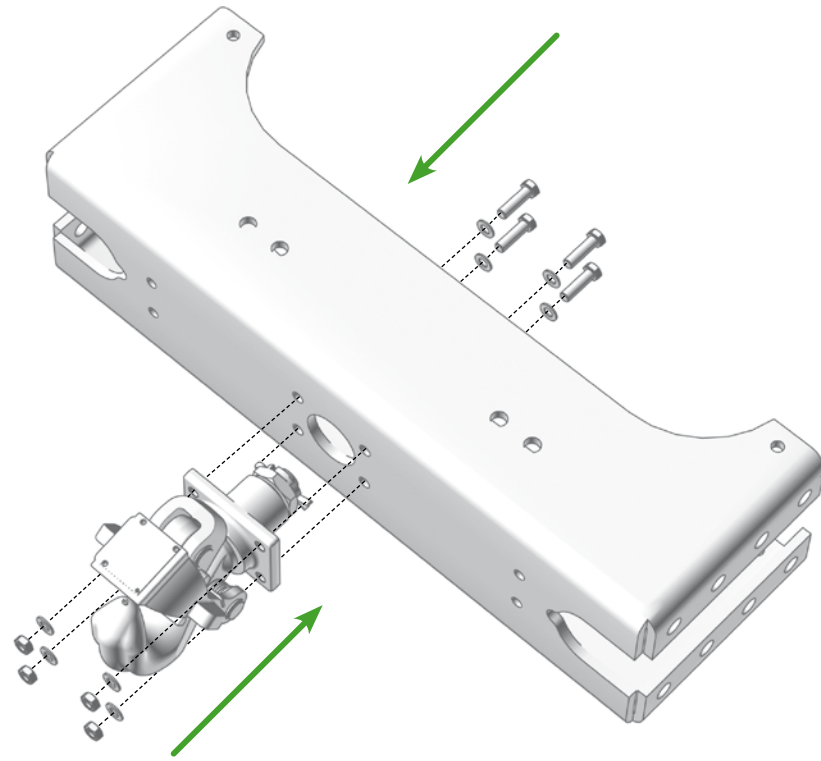

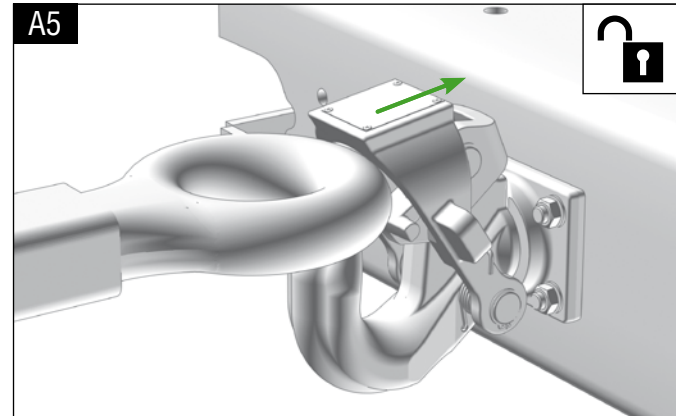
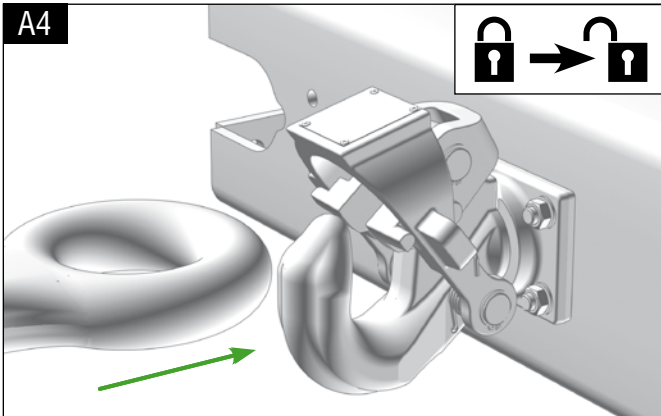
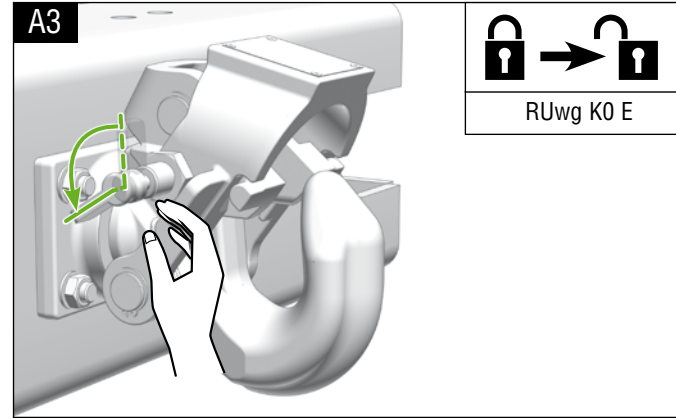
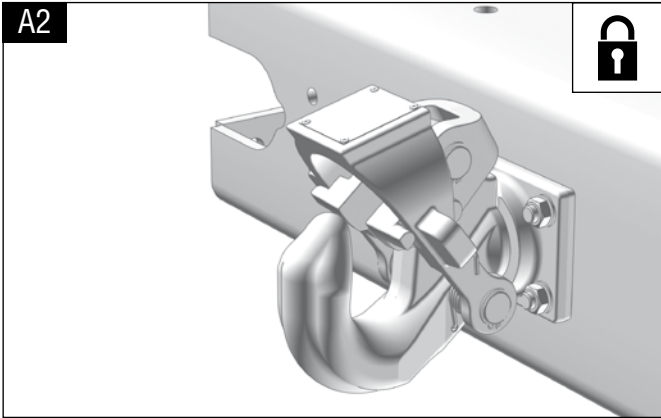

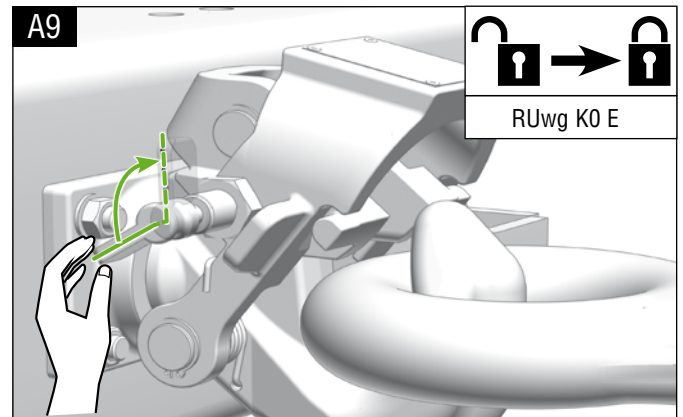
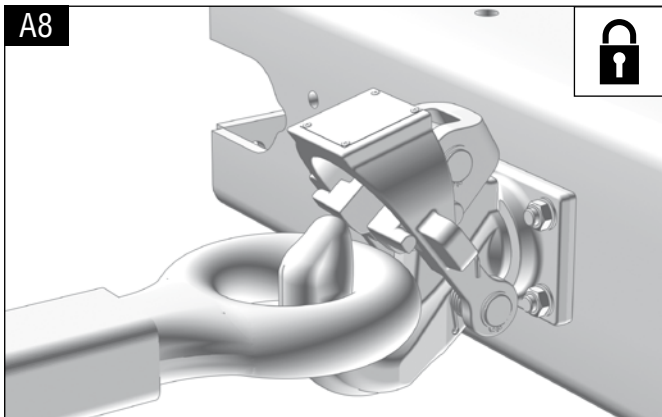
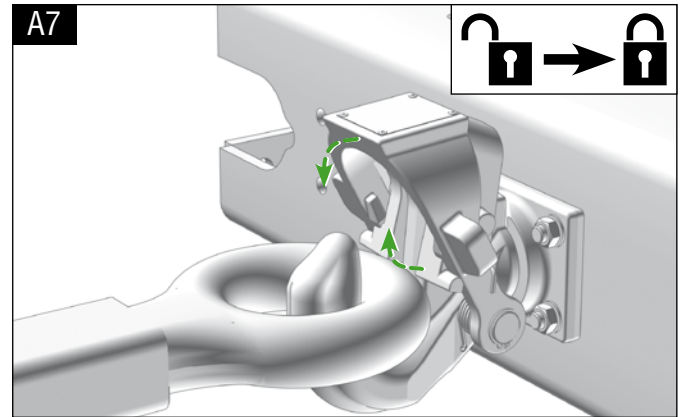
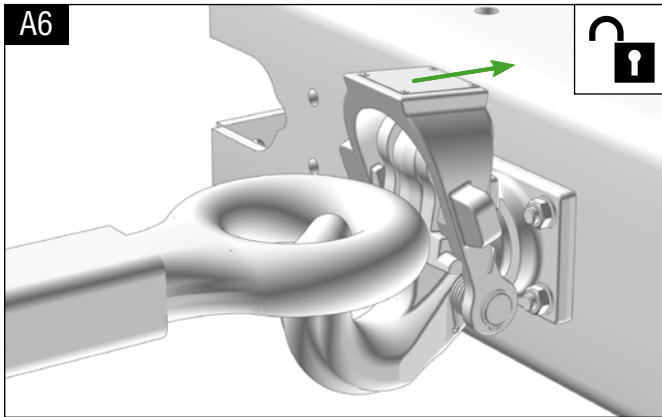

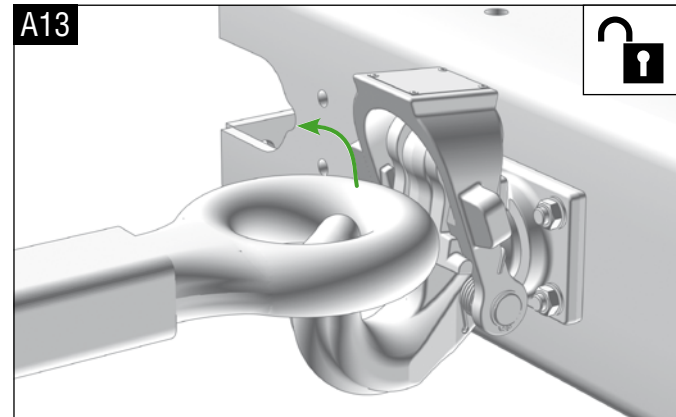
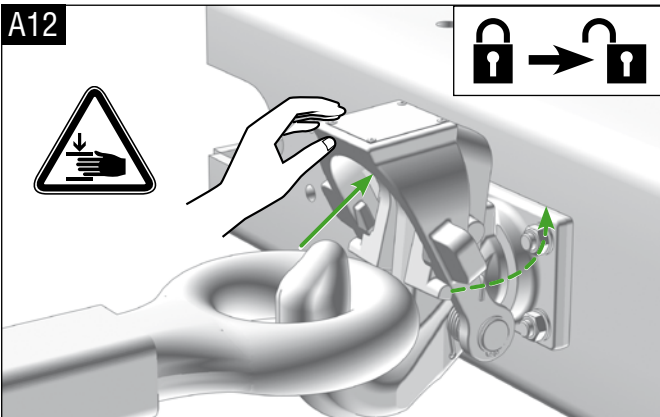
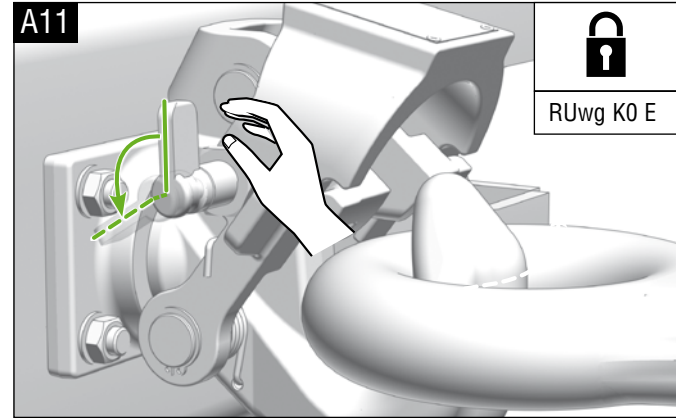
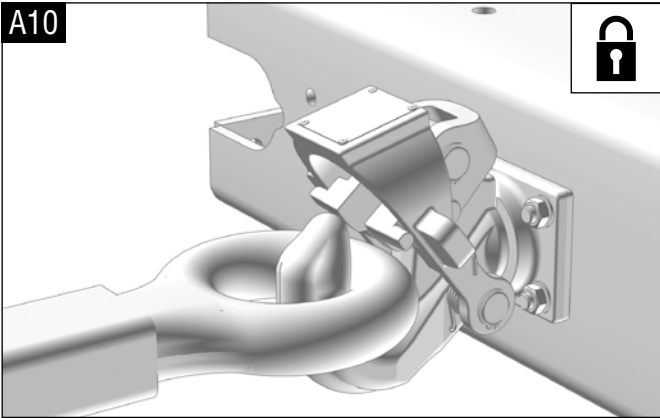

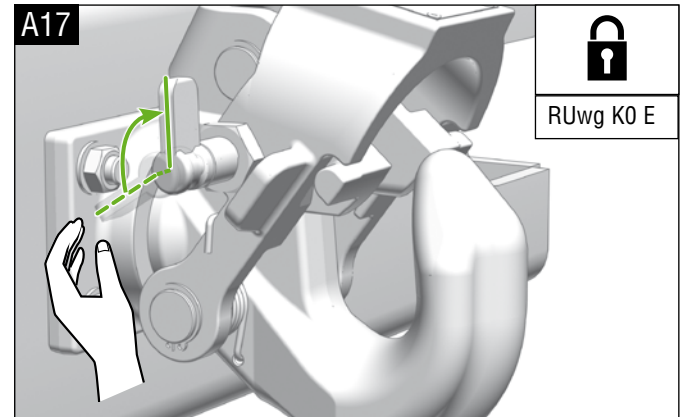
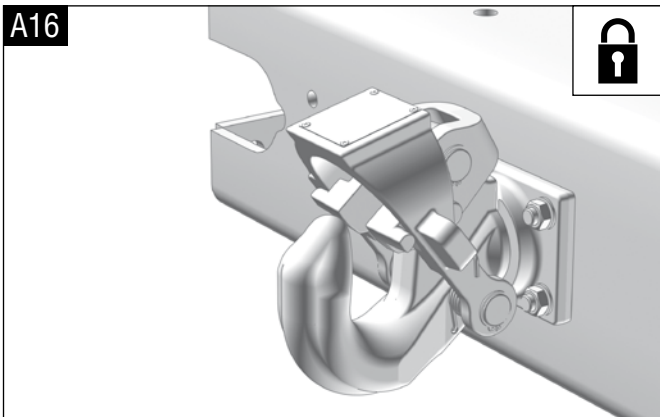
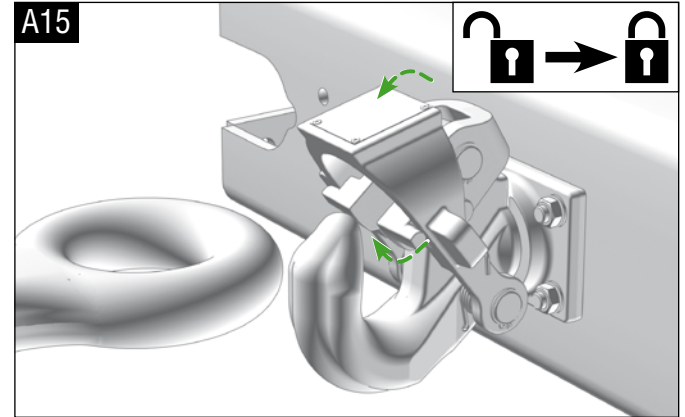
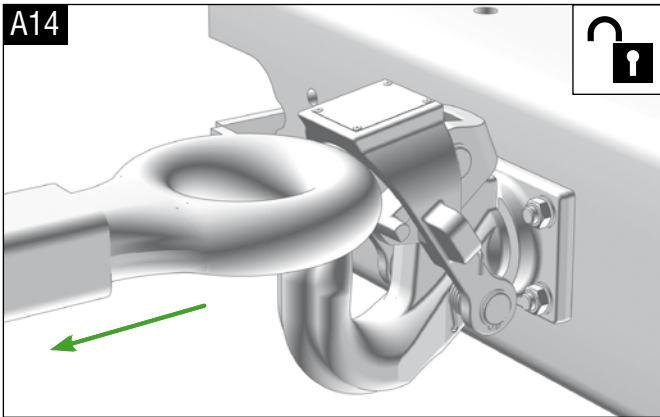



A18

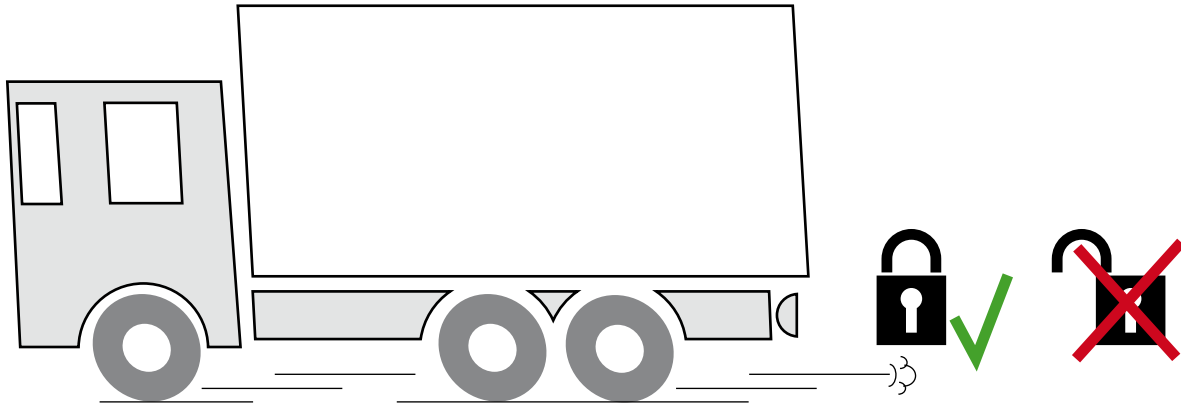



B1



(K0D – K4D): R 22,5 mm

B2

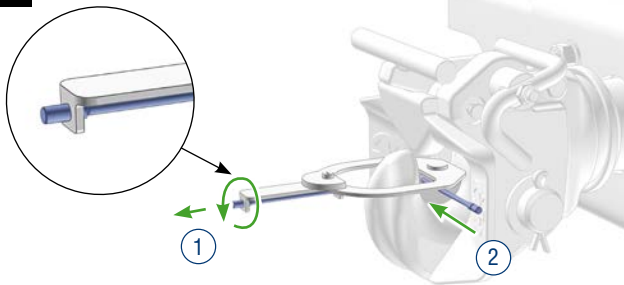

B3

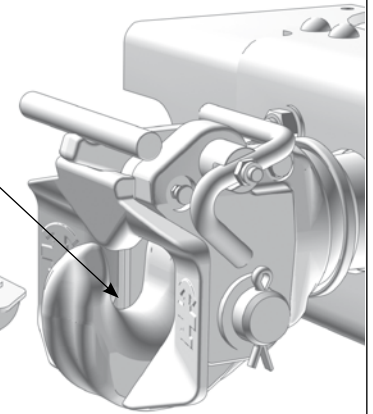
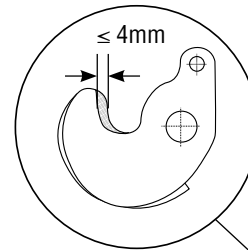

(K0D – K4D): R 22,5 mm



B4

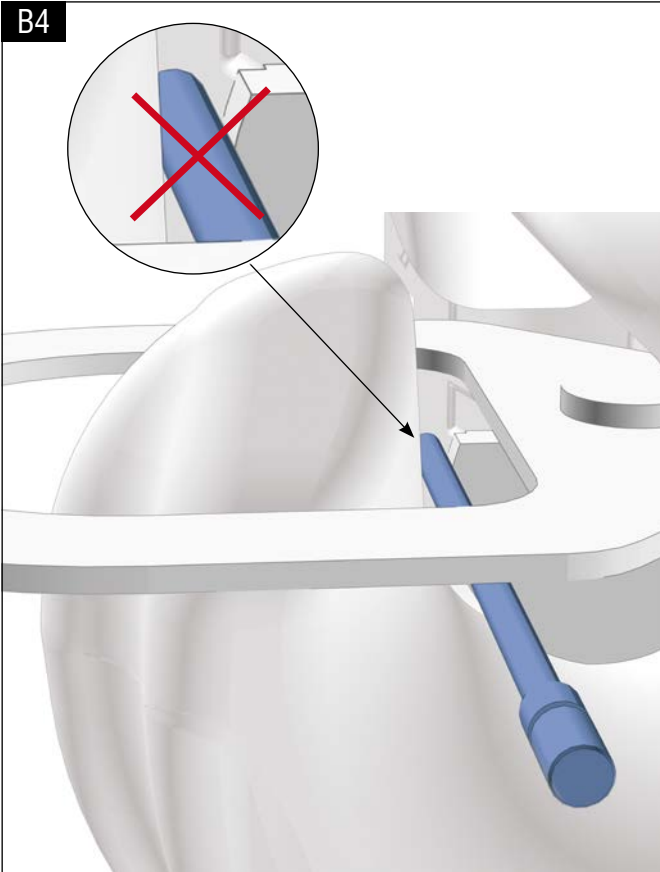

B5

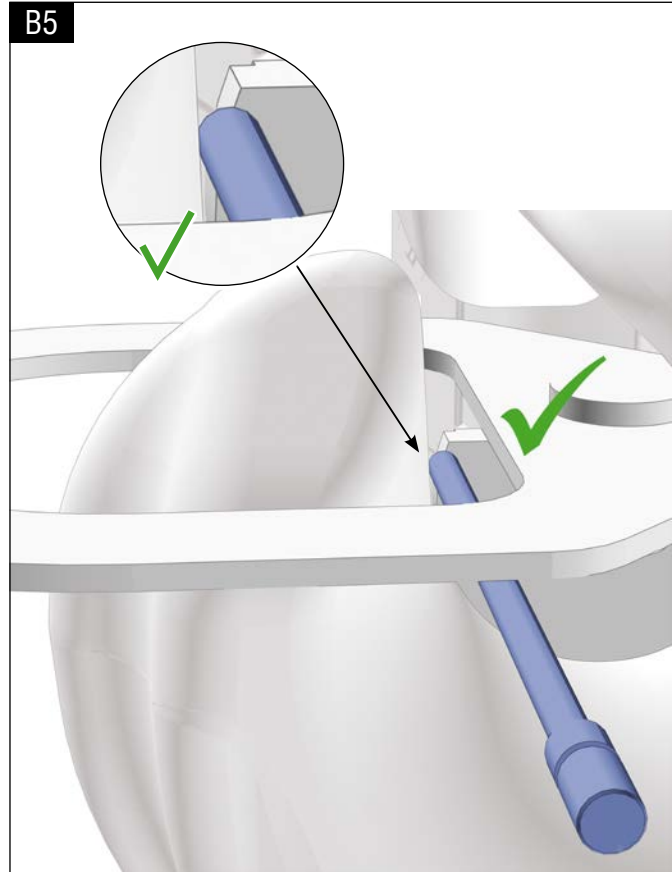



B6

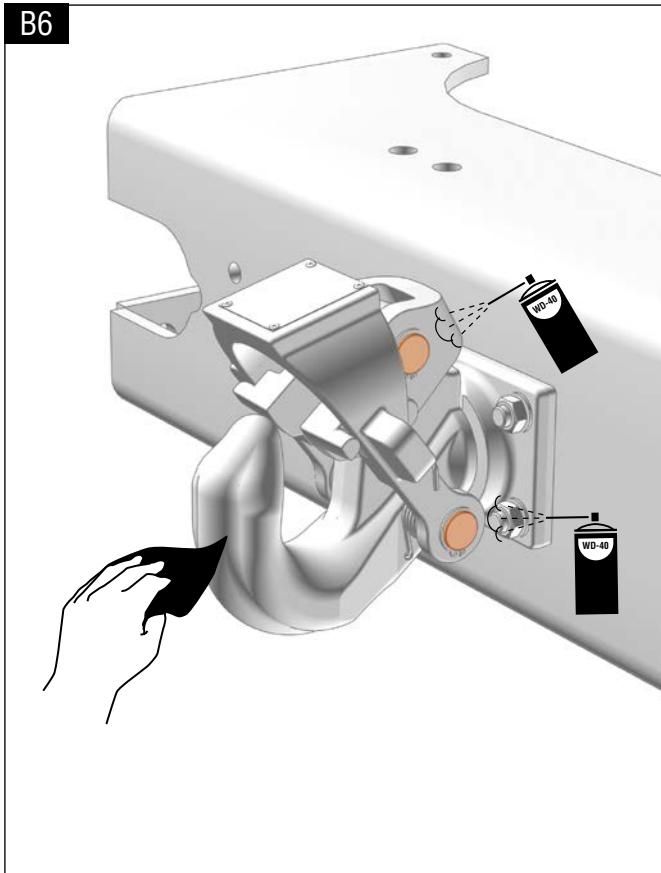

B7

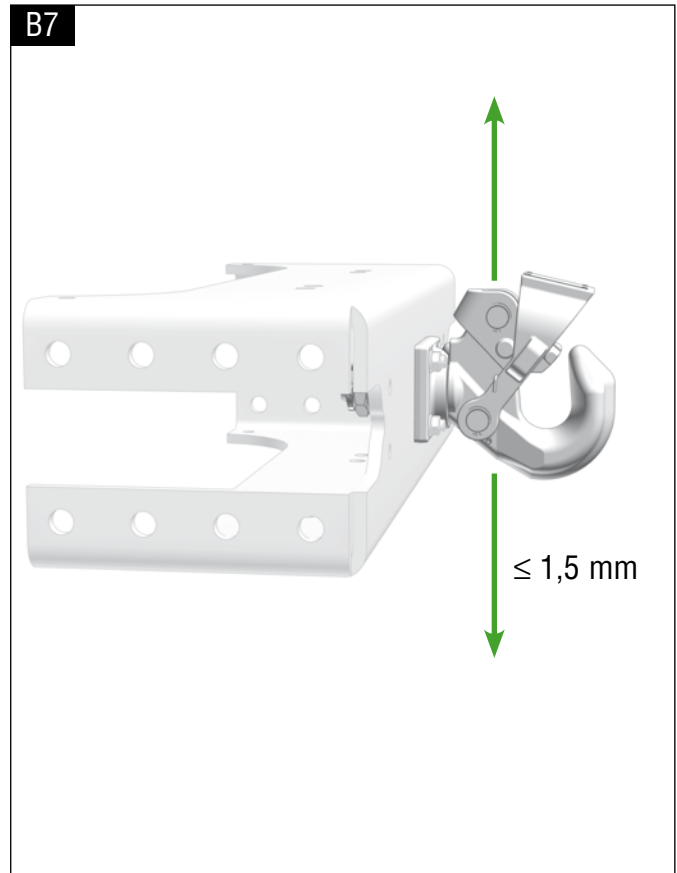



B8

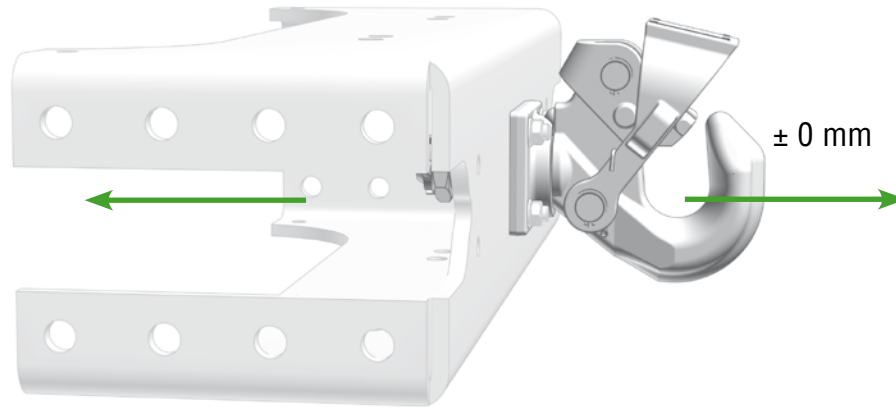



Produced in a certified company DIN EN ISO 9001, ISO TS 16949, DIN EN ISO 14001

VBG GROUP TRUCK EQUIPMENT GMBH · Girmesgath 5 · D-47803 Krefeld
www.ringfeder.de · e-mail: zentrale@vbggroup.com